

## Peckham Grove, Peckham

£450,000



Big and bright two bed (and two bath) warehouse-style apartment with impressive dimensions, exposed brickwork, huge windows, high ceilings, and oversized doors to boot. The cherry on top is a private designated parking space.

Find your new pad in a smart low-rise residential setting, in a notably quiet spot between Peckham and Camberwell centres, really close to Burgess Park's delightful 56 hectares (lake, cafe, tennis and sports courts here).

MUNDAY'S



*Munday's Estate Agents Ltd.*  
2 Mary Boast Walk  
London SE5 8SP  
020 3318 8900

[www.mundays.com](http://www.mundays.com)

MUNDAY'S

## South City Court

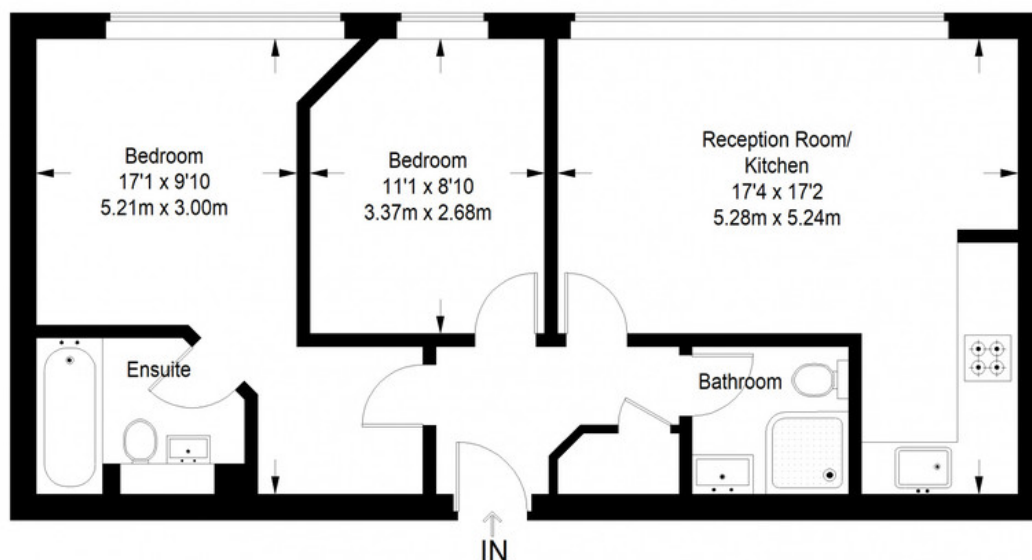

**Third Floor = 640 sq ft**

Approximate Gross Internal Area  
THIRD FLOOR = 640 sq ft / 59.46 sq m  
Total = 640 sq ft / 59.46 sq m



This plan is for layout guidance only. Not drawn to scale unless stated. Windows and door openings are approximate. Whilst every care is taken in the preparation of this plan, please check all dimensions, shapes and compass bearings before making any decisions reliant upon them. (ID357409)

*Munday's Estate Agents Ltd.*  
2 Mary Boast Walk  
London SE5 8SP  
020 3318 8900

[www.mundays.com](http://www.mundays.com)