

MUNDAY'S

Northlands Street, Camberwell

£599,950



Tidy two double bedroom ground floor flat with a private and low-maintenance SE-facing garden (direct access to which is pleasingly from your reception room). The property takes the ground floor of a handsome red-brick flat-fronted Victorian terrace. There are two floors (and flats) above yours.

Find your new home set between the town centres of Camberwell and Brixton, on a residential SE5 back-street, near two Fare Zone 2 stations (Loughborough Junction is six minutes by foot, Denmark Hill Station is 14) and great bus routes on nearby Coldharbour Lane.

*Munday's Estate Agents Ltd.*  
2 Mary Boast Walk  
London SE5 8SP  
020 3318 8900

[www.mundays.com](http://www.mundays.com)

MUNDAY'S



*Munday's Estate Agents Ltd.*  
2 Mary Boast Walk  
London SE5 8SP  
020 3318 8900

[www.mundays.com](http://www.mundays.com)

## Northlands Street

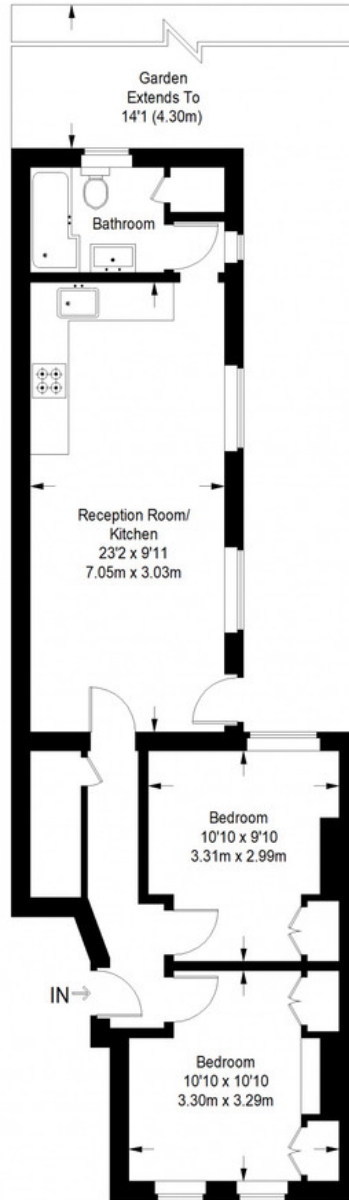

**Ground Floor = 590 sq ft**

Approximate Gross Internal Area  
GROUND FLOOR = 590 sq ft / 54.81 sq m  
Total = 590 sq ft / 54.81 sq m



This plan is for layout guidance only. Not drawn to scale unless stated. Windows and door openings are approximate. Whilst every care is taken in the preparation of this plan, please check all dimensions, shapes and compass bearings before making any decisions reliant upon them. (ID357409)