

MUNDAY'S

Marmont Road, Peckham

£825,000



A classic flat-fronted three bedroom Peckham Victorian terrace of 1009 square feet, with stripped floors and white walls, a low-maintenance west-facing garden (good afternoon sun), a sizeable basement, and a pleasing chain-free status.

You are looking at a quiet residential back-street location (think driving lesson territory), close to central Peckham, and to both Peckham Rye and Queens Road Peckham stations (it is just half a mile to either).

Munday's Estate Agents Ltd.
2 Mary Boast Walk
London SE5 8SP
020 3318 8900

www.mundays.com

MUNDAY'S



Munday's Estate Agents Ltd.
2 Mary Boast Walk
London SE5 8SP
020 3318 8900

www.mundays.com

Marmont Road

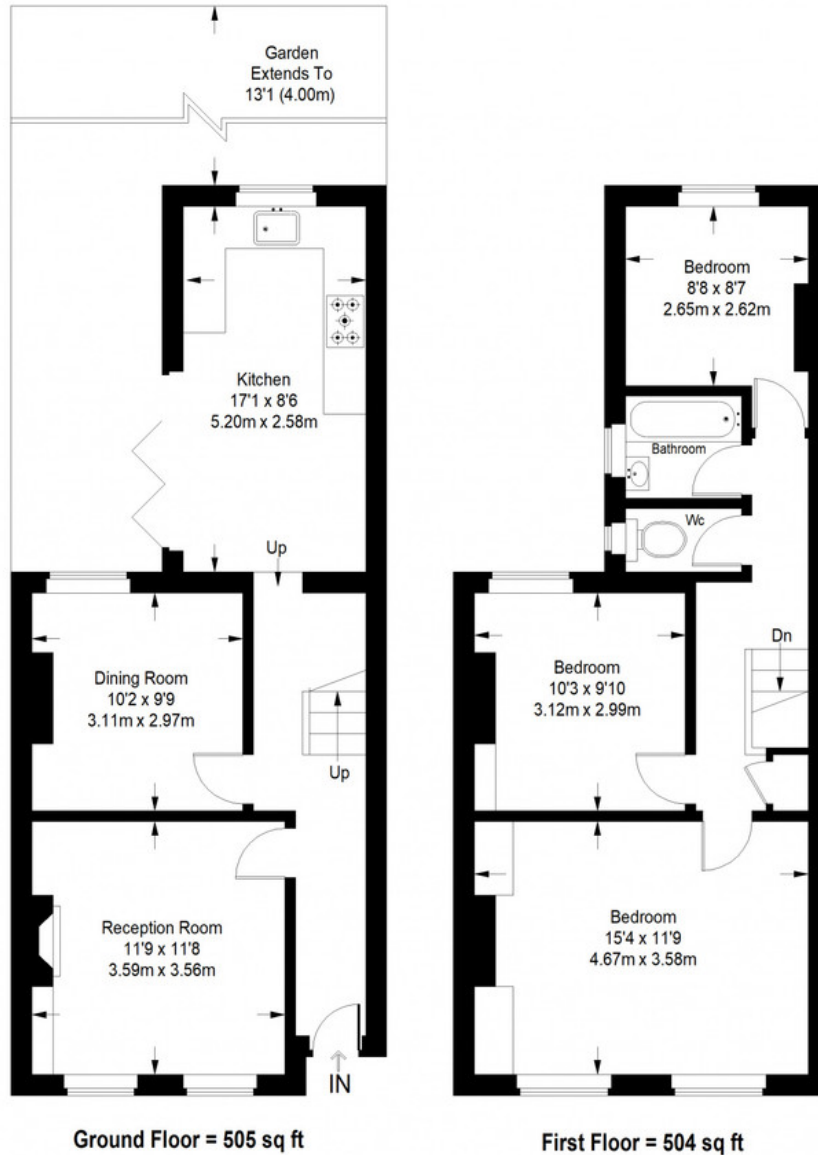

Approximate Gross Internal Area
 GROUND FLOOR = 505 sq ft / 46.91 sq m
 FIRST FLOOR = 504 sq ft / 46.82 sq m
 Total = 1009 sq ft / 93.7 sq m



This plan is for layout guidance only. Not drawn to scale unless stated. Windows and door openings are approximate. Whilst every care is taken in the preparation of this plan, please check all dimensions, shapes and compass bearings before making any decisions reliant upon them. (ID357409)