

Hichisson Road, Nunhead

£525,000



Chain free two bedroom Victorian first floor maisonette with two bedrooms (one double, one single), its own front door, a private sunny SE-facing garden, and a demised loft to boot.

Welcome features include pitch-pine doors, fresh white walls, a modern fitted kitchen, and a smart and bright bathroom. The process has begun for the acquisition of a Freehold-share (as part of this process, the lease will be extended to 999 years before your purchase completes).

This is a popular tree-lined residential side-street in a quiet and friendly community with good connectivity. Your local stations are Nunhead, Peckham Rye, Crofton Park and Brockley; all are circa a mile from the house. Bus links are easy, too, from nearby Cheltenham Road.

MUNDAY'S



Munday's Estate Agents Ltd.
2 Mary Boast Walk
London SE5 8SP
020 3318 8900

www.mundays.com

MUNDAY'S

Hichisson Road,
Nunhead, SE15

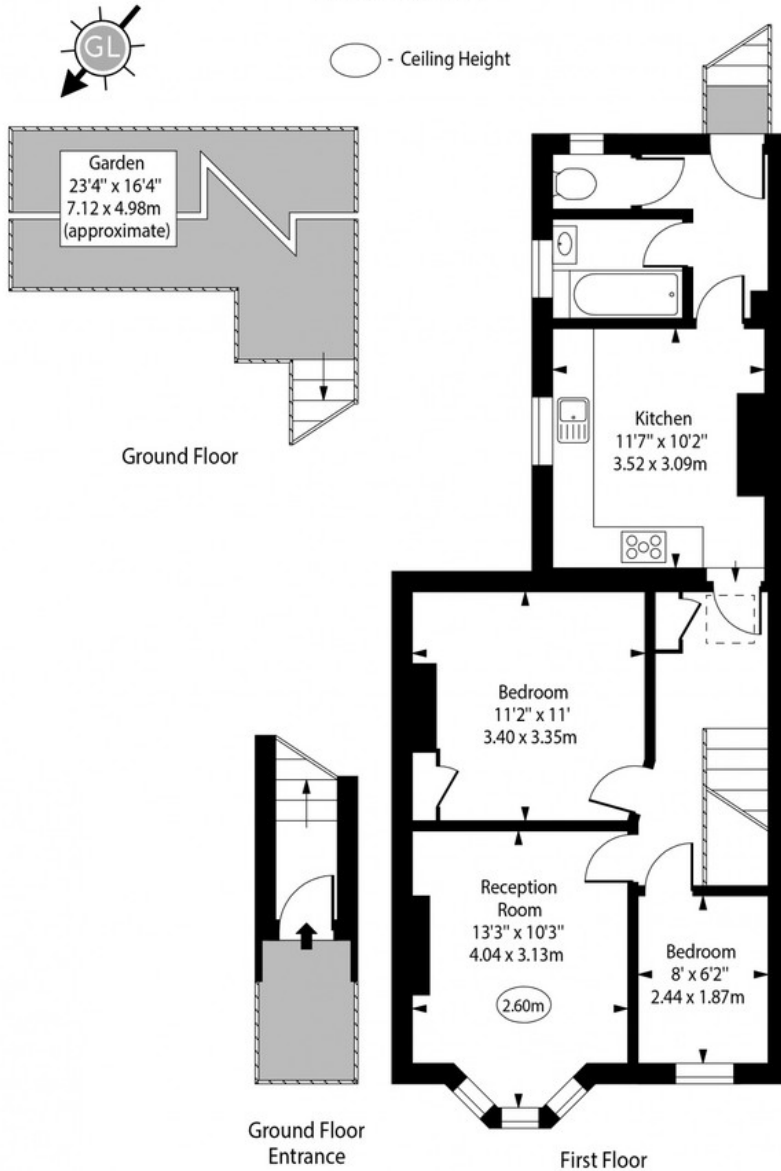

Approx Gross Internal Area

636 Sq Ft - 59.08 Sq M

Every attempt has been made to ensure the accuracy of the floor plan shown.
However, all measurements, fixtures, fittings, and data shown are approximate interpretations and
for illustrative purposes only. Measured according to the RICS. Not To Scale.

www.goldlens.co.uk
Ref. No. 031239D

Munday's Estate Agents Ltd.
2 Mary Boast Walk
London SE5 8SP
020 3318 8900

www.mundays.com