

Crystal Palace Road, East Dulwich

£550,000



Victorian conversion apartment of 565 square feet on the first floor of a smart, semi-detached townhouse, on a popular East Dulwich residential street. Chain free.

Ready for you in February, your new pad - one of just four in this boutique development - has a double bedroom and a generous home office as well. You will also enjoy a lawned and low-maintenance private garden (gated access is from the side of the building) and a new long lease.

You are close to Lordship Lane and North Cross Road, and to two wonderful green spaces: Dulwich Park and Peckham Rye Park and Common. East Dulwich Station (Zone 2) is a circa 15 minute walk.

MUNDAY'S



Munday's Estate Agents Ltd.
2 Mary Boast Walk
London SE5 8SP
020 3318 8900

www.mundays.com

MUNDAY'S

Crystal Palace Road, SE22 First Floor Apartment

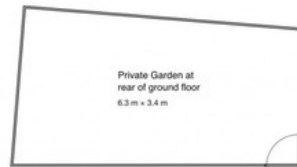

Approximate Gross Internal Area
First Floor = 565 sqft / 52.55 sqm

Whilst every care is taken in the preparation of these plans and images, please check all dimensions, shapes and compass bearings before making any decision reliant upon them.

Munday's Estate Agents Ltd.
2 Mary Boast Walk
London SE5 8SP
020 3318 8900

www.mundays.com